

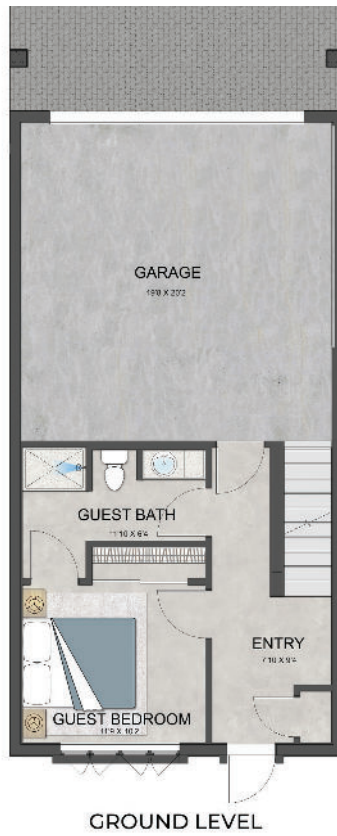

THE TERRACES
AT ROYAL PALM

UNIT D

- Total: 3,440 Sq Ft
- AC: 2,390 Sq Ft
- 3 Bedrooms
- 3 Baths
- 2 Car Garage



GROUND LEVEL

B | D



MAIN LEVEL



SUITE LEVEL

THE TERRACES
AT ROYAL PALM

ROOFTOP LEVEL



1400 Colonial Boulevard
Suite 65
Fort Myers, FL 33907
(239) 268-1013

info@TheTerracesAtRoyalPalm.com

TheTerracesatRoyalPalm.com

©2023. The Terraces At Royal Palm. All features, dimensions, drawings, renderings, plans, specifications, and future amenities are conceptual and subject to change without notice. Pending local government approvals.

TOTAL UNDER A/C - 2,390 Sq Ft
BALCONY - 147 Sq Ft
ROOFTOP - 481 Sq Ft
GARAGE - 422 Sq Ft

TOTAL AREA - 3,440 Sq Ft

