

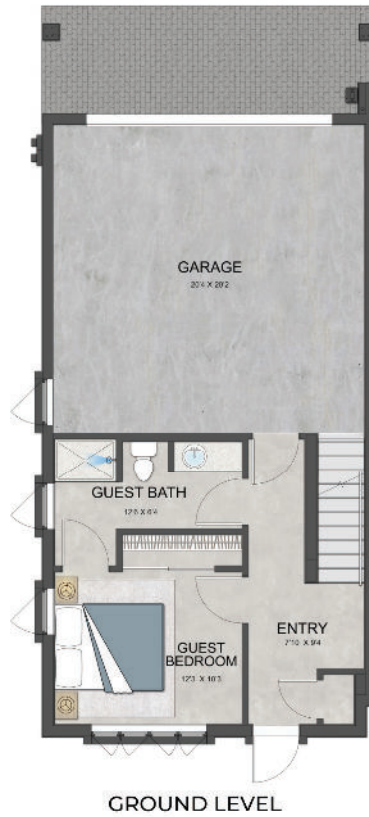

THE TERRACES  
AT ROYAL PALM

## UNIT A

- Total: 3,594 Sq Ft
- AC: 2,487 Sq Ft
- 3 Bedrooms
- 3 Baths
- 2 Car Garage



GROUND LEVEL

**A | E**

MAIN LEVEL



SUITE LEVEL

ROOFTOP LEVEL



THE TERRACES  
AT ROYAL PALM

1400 Colonial Boulevard  
Suite 65  
Fort Myers, FL 33907  
(239) 268-1013

info@TheTerracesAtRoyalPalm.com

[TheTerracesatRoyalPalm.com](http://TheTerracesatRoyalPalm.com)

©2023. The Terraces At Royal Palm. All features, dimensions, drawings, renderings, plans, specifications, and future amenities are conceptual and subject to change without notice. Pending local government approvals.

TOTAL UNDER A/C - 2,487 Sq Ft  
BALCONY - 147 Sq Ft  
ROOFTOP - 519 Sq Ft  
GARAGE - 441 Sq Ft

TOTAL AREA - 3,594 Sq Ft

